



STRIVE FOR PERFECTION  
[www.swiza.com](http://www.swiza.com)



# SWIZA MAGNUS GMT

USER'S MANUAL

# SWIZA MAGNUS GMT USER'S MANUAL

## CONGRATULATIONS!

Your SWIZA MAGNUS GMT watch is equipped with a Swiss Made quartz movement.

This movement has been meticulously designed and manufactured with the highest quality materials and components to protect it against shock, variations in temperature, water and dust.

To ensure that your watch operates with perfect precision, please carefully read and adhere to the instructions included here.

## CARE AND MAINTENANCE

### TEMPERATURE

Do not expose your watch to sudden temperature changes (exposure to sunlight followed by immersion in cold water) or extreme temperatures (over 60°C (140°F) or below 0°C (32°F)).

### SHOCKS AND IMPACTS

Avoid thermal shocks or impacts, since they may harm your watch. In the event of a violent impact please have your watch checked by an approved SWIZA service centre.

### HARMFUL PRODUCTS

Prevent your watch from coming into any direct contact with solvents, detergents, perfumes, cosmetic products, etc., since they may damage the bracelet, the case or the gaskets.

### CLEANING

We would advise you to clean your watch regularly (except for the leather strap) using a soft cloth and lukewarm soapy water. After immersion in salty water, rinse your watch in fresh water and leave it to dry completely.

## SERVICES

Like any precision instrument, a watch must be serviced regularly for optimum operation. As a general rule, we recommend that you have your watch checked every 3 to 4 years by your approved SWIZA retailer or SWIZA service centre. However, please note that depending on the climate and the conditions of use of the watch, a shorter interval may be required. To benefit from the highest standards of service and to ensure your guarantee remains in force, please always contact an approved SWIZA retailer or SWIZA service centre.

## DESCRIPTION OF THE DISPLAY AND CONTROL BUTTONS

### DISPLAY ELEMENTS

Second hand  
Minute hand  
Hour hand  
Date



### CONTROL BUTTONS

Crown

## SETTING THE TIME

- 1 Pull the crown out to position III (watch stopped)
- 2 \*Turn the crown until the current time is displayed.
- 3 Push the crown back into position I

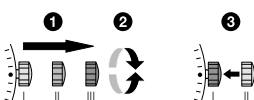

\*Please observe the 24-hour cycle

## QUICK-CHANGE CORRECTION FOR DATE

- 1 Pull the crown out to position II (watch still running)
- 2 Turn the crown clockwise until the desired date appears
- 3 Push the crown back into position I



The date can also be corrected during the day-changing phase between 10 pm and midnight.

The date of the following day has to be set, because no automatic date change takes place at midnight.

## BATTERY

- Battery type: 371 (Ø 9.5 mm x 2.05 mm / SR 920 SW)

## QUICK-CHANGE CORRECTION FOR 24-HOUR DISPLAY

- 1 Pull the crown out to position II (watch still running)
- 2 Turn the crown anticlockwise until the desired time appears
- 3 Push the crown back into position I

